

VIA SERRADIFALCO

CIVICO 190
INGRESSO 1+B5

PIANO TERRA

INGRESSO 1 = T01(3m)+T02(3i)+T24(1g)

CIVICO 188
INGRESSO
A2+A3

INGRESSO B5=
104(2L)+105(3L)+106(1L)+107(3
d)+205(2d)+206(1d)+207(3a)

B5

INGRESSO
SCALA B

A2

INGRESSO
A2=101(2h)+102(2g)+121(3h)+201(1
e)+202(2e)+203(1c)+221(3c)

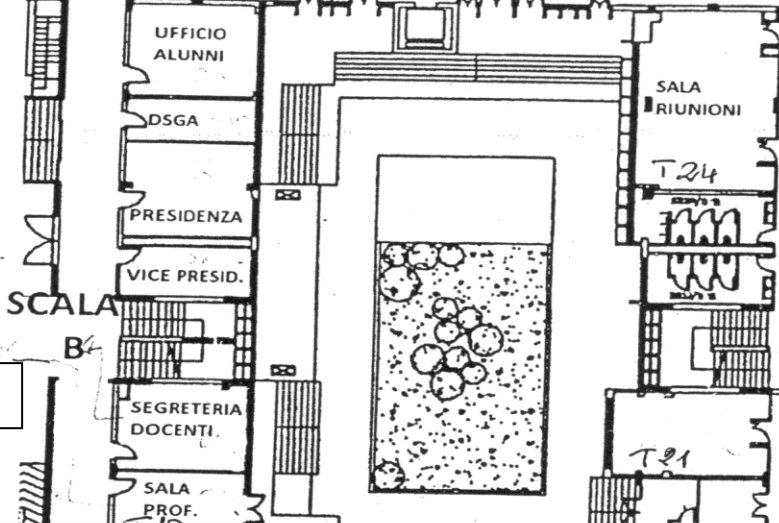

A3

INGRESSO A3=
114(1m)+115(2m)+118(3g)+215(2c)+21
6(3e)+218(1a)

INGRESSO B4=
111(1i)+112(2i)+113(2a)+211(3b)
+212(2b)+213(1b)

B4

T14 T15

REFETTORIO

INGRESSO B4

VIA FALCANDO